

XPOD X30

Designation: Residential

Shell cost starting from R447,350 (Incl. VAT)

- The Units are available in a Steel and Boarded prefabricated floor or concrete raft foundation, dependent on choice and/or site conditions.
- Please note that cut & fill not included in costings. (methodology mitigates the need for cut & fill over gentle slopes)
- The Shell costs exclude Sanitaryware and kitchen fit-out. These are available according to a choice of schemes available upon enquiry.
- Shell price includes a Composite Decked Veranda with louvre covering (Patio sizes as per respective Plans)
- All Engineering & Architectural services included according to standard schemes offered. All Interior Fittings; Fixtures & Equipment not included
- Aluminium Framed Windows & Doors, OSB / Plaster Board ceilings and Plaster & paint interior finish.
- The Pre-fabricated Steel Foundation offers a choice of OSB, Vinyl or Carpet floor finishes. The Raft Foundations offering can be tiled in addition to vinyl/ carpeting finishes
- The Units have an Insulated Chromadek IBR Roof, available in standard colours.
- The Units come with an initial Electrical Spec which can either be connected to the respective Power provider or paired with an appropriate alternative energy solution.
- The Units are plumbed according to the various plans available, however, will require connecting to preferred Water Supply & Waste Water System
- Fabrication time? 4-6 weeks? Installation time? 3-5 weeks depending on the type of Foundation?
- All Dwellings do require Council Submission, Council Submission not included, but service is offered separately.
- We do offer Garage/storage versions depending on one's requirements.
- Naturally one can add / mix & match with the various Units on offer via a glazed passage. but this is site dependant and based on where appropriate/ feasible.

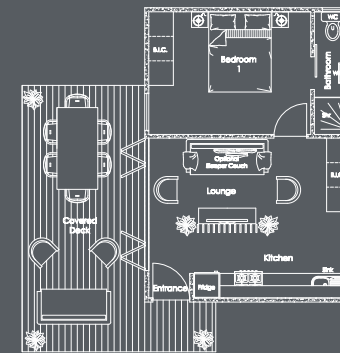

X-30 PLAN
OPTION 1

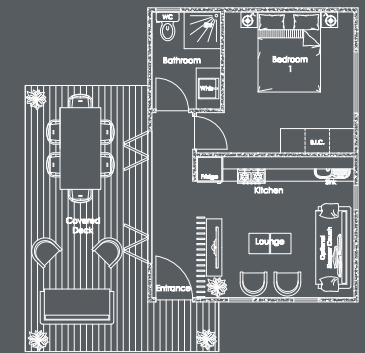

X-30 PLAN
OPTION 2



Manufacture
4-6 Weeks



Off grid
Solar/Energy
options available



Double glazing
Available



Installation
3-5 Weeks



On grid
Plugs into mains



Insulation
Year round comfort

BIOBUILD

**GRÉMENT
SOUTH AFRICA**
PROPERTY CONSULTANT PRODUCT ASSOCIATION

While using the thermal and acoustic efficiencies of wood and the structural qualities of cement, Biobuild® provides a unique ecological & economical alternative to traditional building materials.

www.Xpod.co.za

Contact Info@multiplyholdings.com

MULTIPLY.

*Prices include manufacture and installation but exclude delivery. T's & C's apply.